

TM9-2320-211-34P

(1) (2) (3) (4) (5) (6) (7) (8) (9) (10)

SMR Federal DESCRIP Federal UNIT 30 dia 30 dia 30 dia 30 dia 30 dia 30 dia 30 dia 30 dia 30 dia 30 dia

Code Stock Number of inc. allowance allowance alw maint per alw (a) (b) meas in Unit 100 per equip 100 Figure Item

Reference Number & Mfr. Code Usable On Code (a) (b) (c) (a) (b) (c) cnt- equip No. No.

1-20 21-5(51-10) 1-20 21-5(51-10) gcy

1812-SPECIAL PURPOSE BODIES--CONTINUED  
NON-ILLUSTRATED--CONTINUED

P-F 5930-679-15 SWITCH, PUSH: SOLID SIDE CE,CF,CG EA 2 \* \* \* \* \* \* \* 6 8  
8342288 (19207)

P-O 5975-335-25 TUBE, FLEXIBLE, NONMETALLIC: CE,CF,CG FT V \* \* \* \* \* \* \* 3 5  
8376125 (19207)

GROUP 20-HOIST, WINCH AND POWER  
CONTROL AND POWER  
TAKE-OFF

2001-HOIST, WINCH, CRANE ASSEMBLY

P-O-R 2590-741-11 WINCH ASSEMBLY: FRONT HA,JA,FJ EA 1 \* \* \* \* \* \* \* 6 10 208 1  
7411122 (19207)

P-F 2590-121-07 SHEAVE ASSEMBLY, WINCH: EA 1 \* \* \* \* \* \* \* 4 5 208 2  
7954483 (19207)

P-F 5305-054-92 SCREW, CAP, HEXAGON HEAD: EA 2 \* \* \* \* \* \* \* 6 10 208 3  
TRACK ASSEMBLY  
MS51955-77 (96906)

P-F 5310-834-87 NUT, PLAIN: TRACK ASSEMBLY EA 4 \* \* \* \* \* \* \* 6 10 208 4  
MS356919-33 (96906)

P-F 5305-044-55 SCREW, CAP, HEXAGON HEAD: EA 1 \* \* \* \* \* \* \* 6 10 208 5  
MS90725-160 (96906)

P-F 5310-820-66 WASHER, LOCK: TRACK ASSEMBLY EA 1 \* \* \* \* \* \* \* 6 10 208 6  
MS35338-50 (96906)

X1 TRACK ASSEMBLY: 1 208 7  
8344234 (19207)

P-O 2590-641-64 WINCH, ASSEMBLY: WITH ROLLER HA,JA,FJ EA 1 \* \* \* \* \* \* \* 6 10 208 8  
7412382 (19207)

P-F 2590-118-55 DRUM ASSEMBLY, WINCH: EA 1 \* \* \* \* \* \* \* 4 5 208 9  
7954477 (19207)

P-F 5305-051-08 SCREW, CAP, HEXAGON HEAD: EA 4 \* \* \* \* \* \* \* 6 10 208 10  
ROLLER ASSEMBLY  
MS90725-164 (96906)

P-F 5310-820-66 WASHER, LOCK: ROLLER ASSEMBLY EA 4 \* \* \* \* \* \* \* 6 10 208 11  
MS35338-51 (96906)

P-F 5310-584-78 WASHER, LOCK: ROLLER ASSEMBLY EA 12 \* \* \* \* \* \* \* 6 10 208 12  
MS35338-51 (96906)

P-F 5310-584-78 WASHER, LOCK: ROLLER ASSEMBLY EA 12 \* \* \* \* \* \* \* 6 10 208 12  
MS35338-51 (96906)

P-F 5305-939-92 SCREW, CAP, HEXAGON HEAD: EA 12 \* \* \* \* \* \* \* 6 10 208 13  
ROLLER ASSEMBLY  
MS90725-187 (96906)



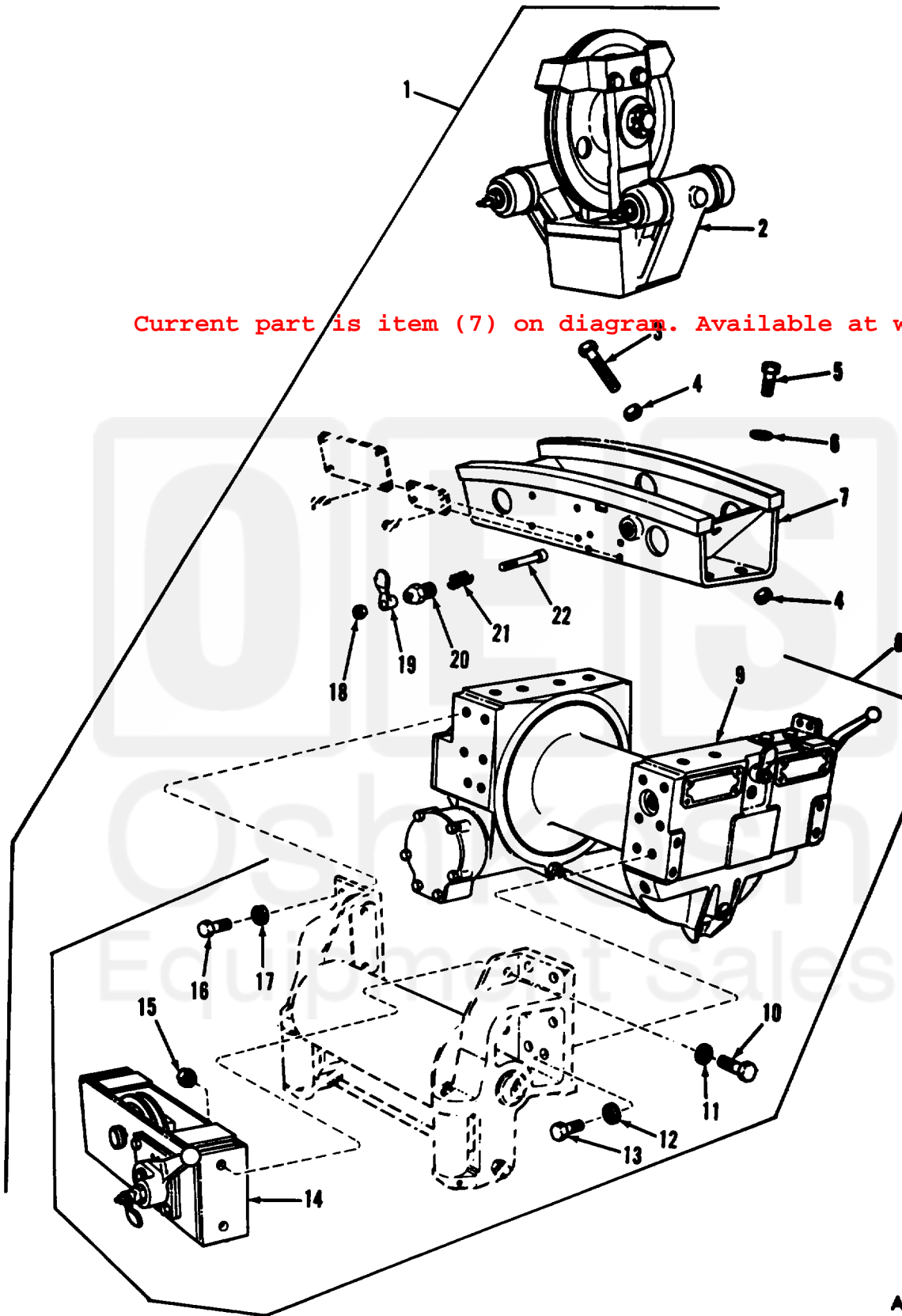

Current part is item (7) on diagram. Available at [www.oshkoshequip.com](http://www.oshkoshequip.com)

AT 47303

Figure 208. Front winch assembly.

Current part is item (7) on diagram. Available at [www.oshkoshequip.com](http://www.oshkoshequip.com)